

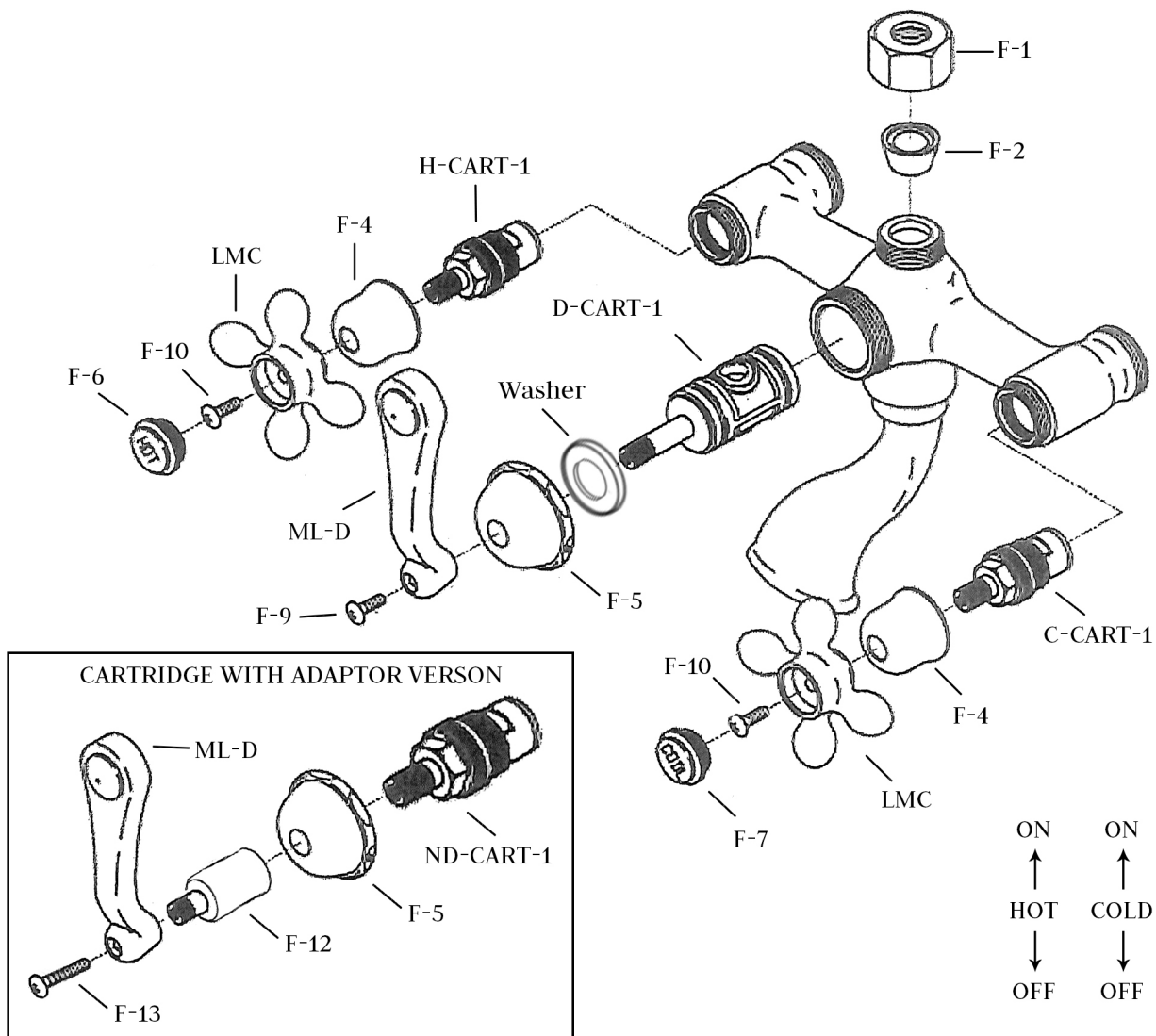

English Telephone Faucet Body

by Randolph Morris

Item#: RM146-RMNSL4



Unpack and check all the parts, and read the instructions.

PART NO.	DESCRIPTION	QTY
C-CART-1	COLD CARTRIDGE (BLUE)	1
D-CART-1	DIVERTER CARTRIDGE	1
F-1	RISER NUT	1
F-2	RISER CONE WASHER	1
F-4	BELL NUT - HOT & COLD	2
F-5	DIVERTER BELL NUT	1
F-6	HOT CERAMIC BUTTON	1
F-7	COLD CERAMIC BUTTON	1
F-9	FINISHED SCREW	1
F-10	UNFINISHED SCREW	2
F-12	ADAPTOR	1
F-13	LONG FINISHED SCREW	1
H-CART-1	HOT CARTRIDGE (RED)	1
LMC	CROSS HANDLE	2
ML-D	DIVERTER HANDLE	1
ND-CART-1	DIVERTER CARTRIDGE (ADAPTOR VERSION)	1

Approximate Measurements. All products and specifications are subject to change without notice. Randolph Morris is not responsible for typographical and/or dimensional errors. Typographical errors are subject to correction.



Handshower & Cradle

by Randolph Morris

Item#: RM146-RMNSL4

Unpack and check all the parts, and read the instructions.

PART NO.	DESCRIPTION	QTY
CK-1	HANDSHOWER HEAD	1
CK-2	HANDSHOWER HANDLE	1
CK-3	HANDSHOWER HOSE	1
CK-4	HANDSHOWER HOSE WASHERS	2
CK-10	HANDSHOWER FAUCET CRADLE	1
CK-11	HANDSHOWER CRADLE WASHER	1

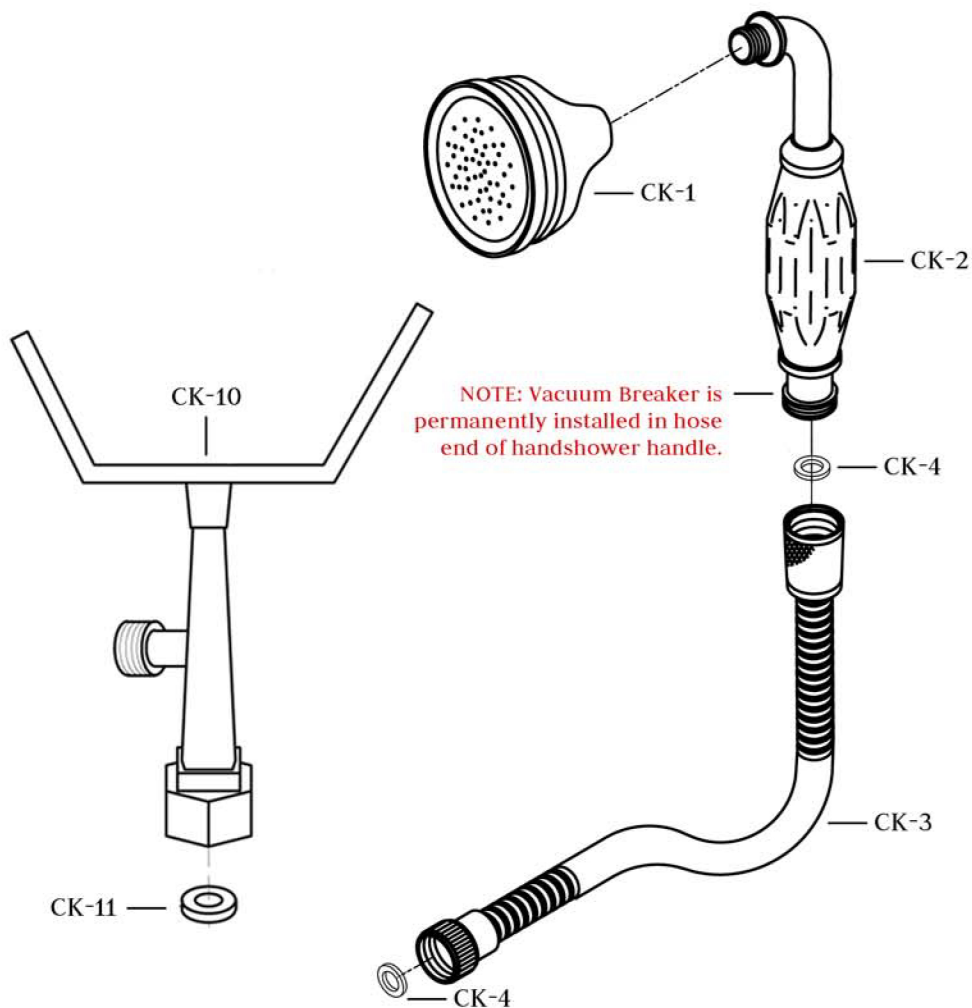



Clawfoot Tub Freestanding Supply Lines

by Randolph Morris

Item#: RM146-RMNSL4

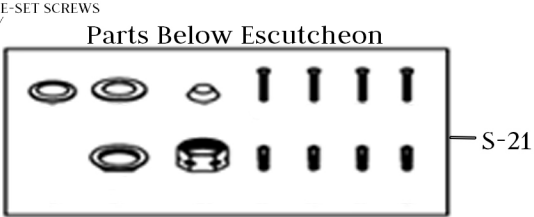
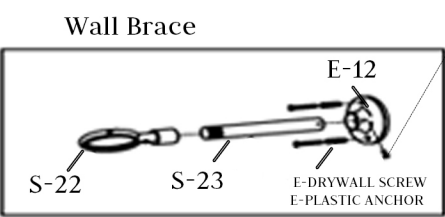
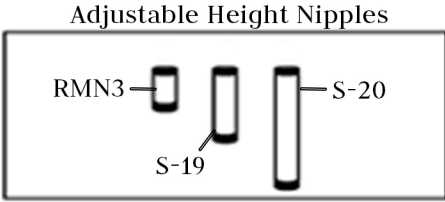
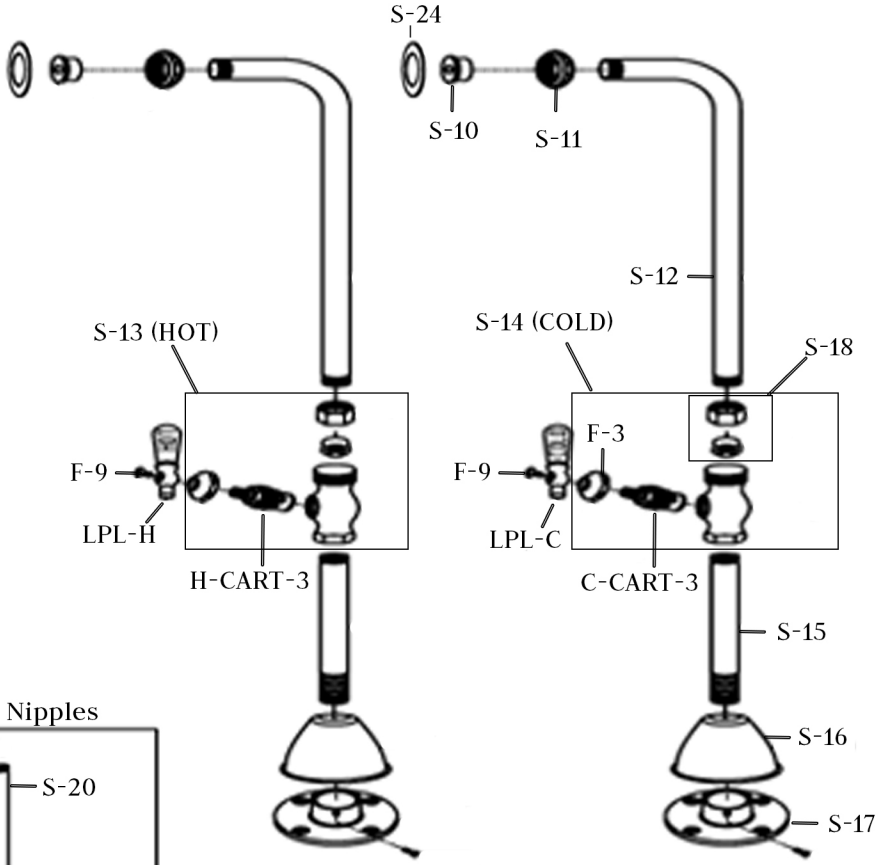

Unpack and check all the parts, and read the instructions.

ITEM	DESCRIPTION	QTY
C-CART-3	COLD STEM	1
H-CART-3	HOT STEM	1
E-12	FLANGE	2
E-DRYWALL SCREW	DRYWALL SCREW	4
E-PLASTIC ANCHOR	PLASTIC ANCHOR	4
E-SET SCREWS	SCREW (FINISHED)	4
F-3	BELL NUT	2
F-9	SCREW	2
LPL-C	COLD HANDLE	1
LPL-H	HOT HANDLE	1
RMN3	3" NIPPLE	2
S-10	THREADED CONNECTOR	2
S-11	NUT	2
S-12	SHORT THROW TUBE	2
S-15	7.5" NIPPLE	2
S-16	ESCUTCHEON	2
S-17	FLANGE	2
S-18	NUT WITH FLANGE	2
S-19	6" NIPPLE	2
S-20	9" NIPPLE	2
S-21	HARDWARE BAG	1
S-22	LOOP INCLUDES E-SET SCREWS	2
S-23	12" TUBE	2
S-24	WASHER	2

Approximate Measurements. All products and specifications are subject to change without notice. Randolph Morris is not responsible for typographical and/or dimensional errors. Typographical errors are subject to correction. Note: Rough-in dimensions may vary +/- 1/2" and are subject to change. No responsibility is assumed by Randolph Morris.